

### Freestanding Dual Vertical

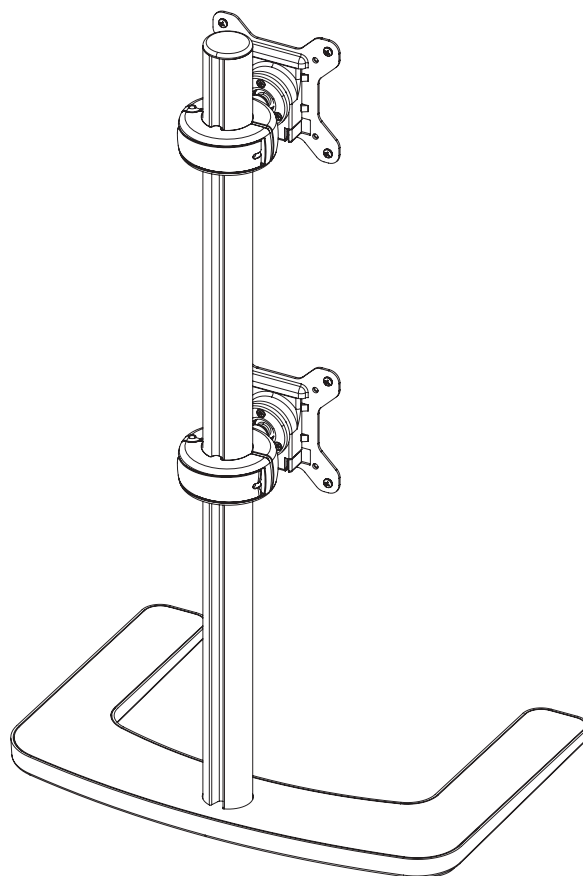

#### FEATURES

- Supports up to two 49" monitors (see dimensions below to confirm monitor size is suitable for this mount).
- Compatible with Grommet Clamp (AC-GC) for bolt through or grommet installation.
- Quick monitor release/attachment mechanism.
- Generous cable management guides cables discreetly down to the work surface.
- Switch to a single monitor mount by removing one doughnut.

**Monitor weight**

Suits flat or curved monitors

0-12kg (0 - 26.5lb)\*  
per monitor

**Max Vertical Height**

741mm (29.17")

**Tilt angle**

+/- 20°

**Monitor rotation**

360°

**VESA mounting**

75x75 | 100x100

\*Curved monitors, deep devices (such as all-in-one PCs) and offset VESA locations exert additional leverage that can exceed the capacity of the mount even though the monitor weight may be within the stated range. Please contact Atdec if you would like further information.

#### WARRANTY

10 years limited

## MOVEMENT

1. Vertical height adjustment
2. 360° Portrait/Landscape adjustment
3.  $\pm 20^\circ$  Pan/Tilt adjustment
4. 360° Rotation

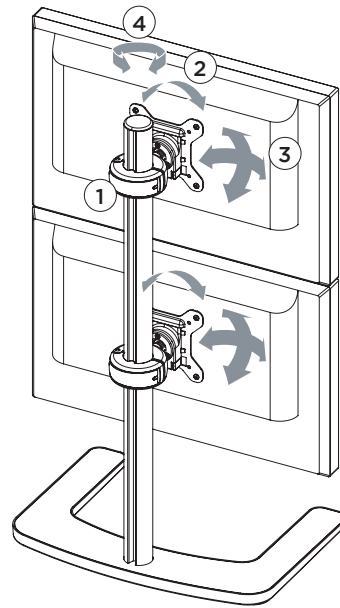

## DIMENSIONS

**MAX HEIGHT  
PER MONITOR\***  
up to 450mm  
(17.72")  
from edge to  
edge.

\*All monitors same dimensions  
with VESA mount centrally  
located on rear face of monitor.

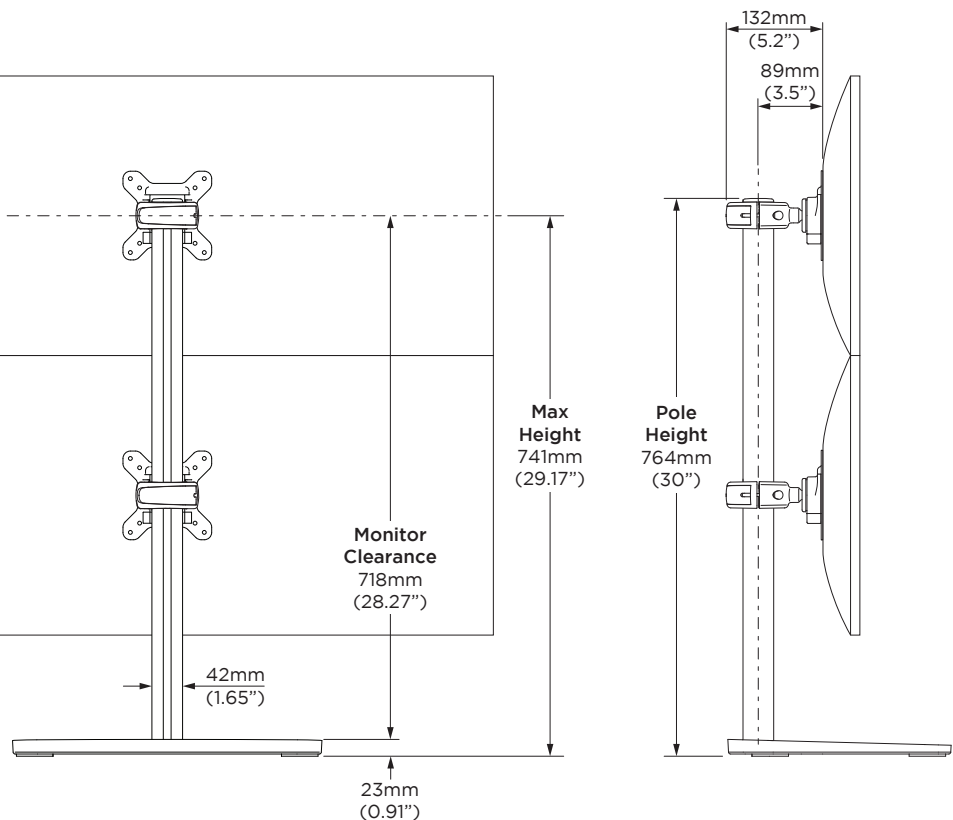

## BASE DIMENSIONS

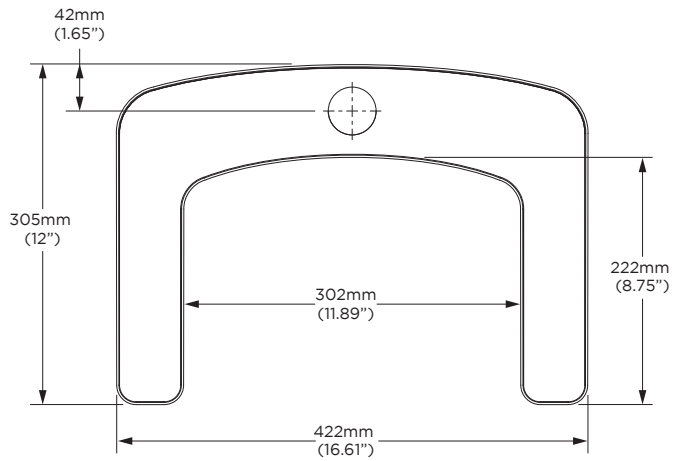

## VESA DISPLAY MOUNTING OPTIONS

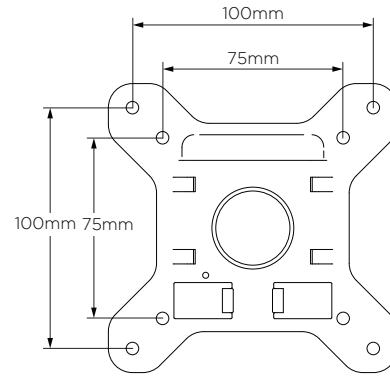

## OPTIONAL CONFIGURATIONS

